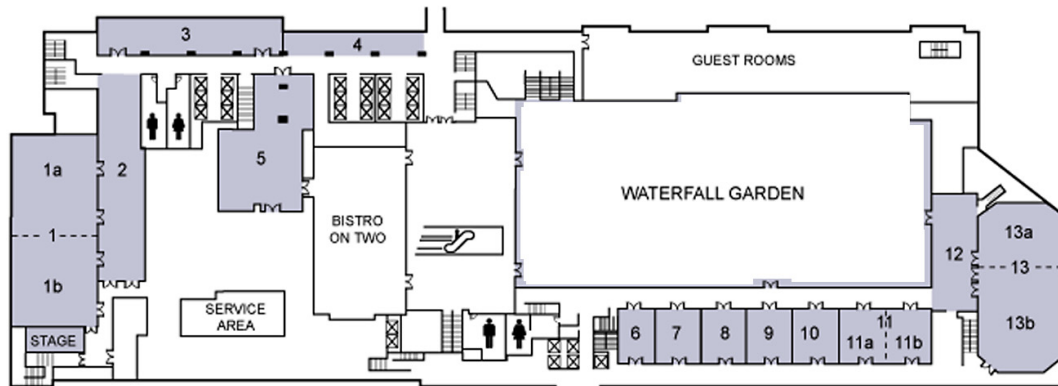

EXHIBIT HALL LAYOUT (subject to change)



- | | | |
|--|--|--|
| 1. DOMINION BALLROOM
1a. DOMINION BALLROOM NORTH
1b. DOMINION BALLROOM SOUTH | 6. ELGIN ROOM
7. WENTWORTH ROOM
8. KENORA ROOM
9. HURON ROOM
10. KENT ROOM | 11. SIMCOE ROOM & DUFFERIN ROOM
11a. SIMCOE ROOM
11b. DUFFERIN ROOM |
| 2. DOMINION BALLROOM FOYER
3. CHURCHILL ROOM
4. CHURCHILL FOYER
5. CITY HALL ROOM | | 12. CIVIC BALLROOM FOYER
13. CIVIC BALLROOM
13a. CIVIC BALLROOM NORTH
13b. CIVIC BALLROOM SOUTH |

Second Floor

- 1 Dominion Ballroom – Main Session
 - 1a Dominion Ballroom North – Concurrent Session
 - 1b Dominion Ballroom South – Concurrent Session
- 2 Dominion Ballroom Foyer – Exhibits (12)
- 3 Churchill Room – Exhibits (6)
- 4 Churchill Foyer – Exhibits (6)
- 5 City Hall Room – Exhibits (11)
- 6 Elgin Room – Speaker Ready Room / Office
- 7 Wentworth Room – Posters (30)
- 8 Kenora Room – Posters (36)
- 9 Huron Room – Posters (38)
- 10 Kent Room – Posters (35)
- 11 a Simcoe
 - b Dufferin – Concurrent Session

Total Exhibit Booths (35) –

Able to add 2 more booths in lobby area - Total (37)